

# AIR COOLED, TWO STAGE MODELS E-50 & E-71

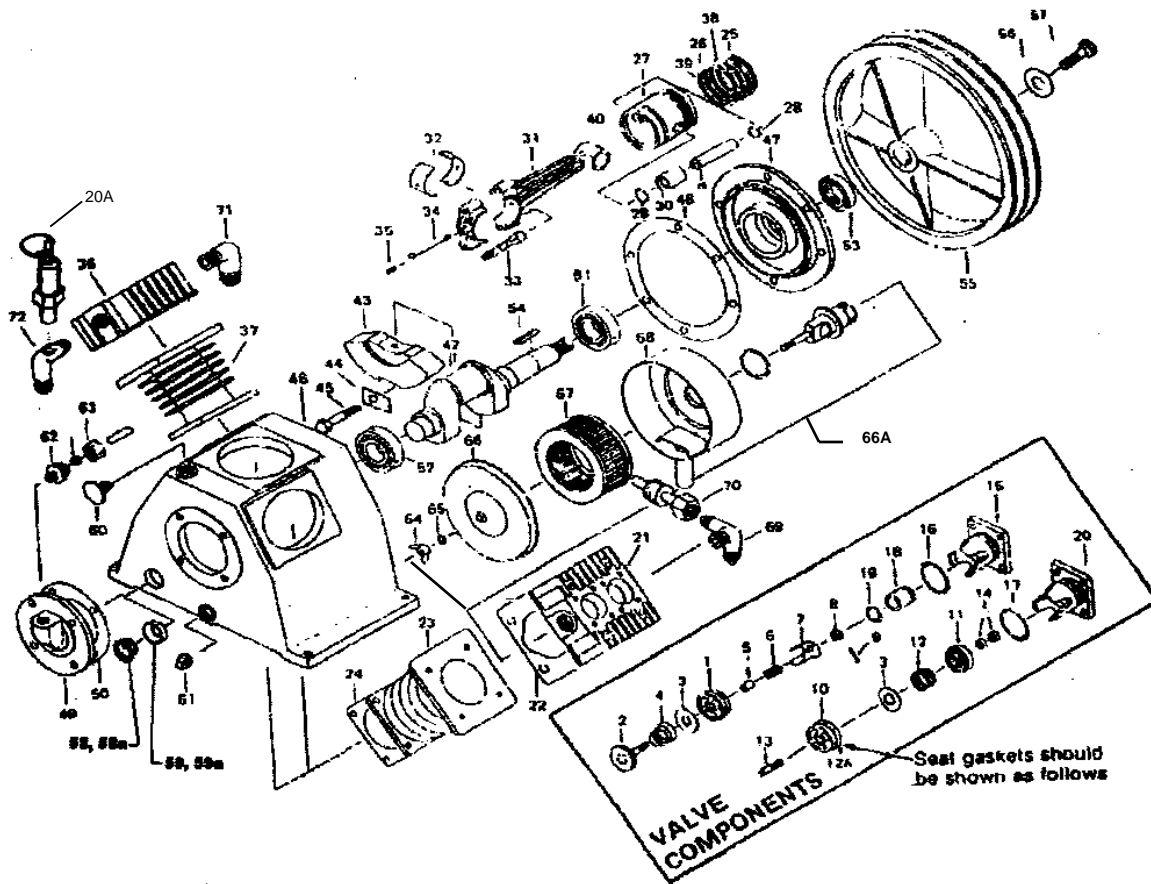

VALVE ASSEMBLIES	DESCRIPTIONS	Qty. Req.	MODEL E50		Qty. Req.	MODEL E71	
	Inlet Valve Assembly, 1 <sup>st</sup> Stage	2	70123-31000		2	70124-31000	
	Inlet Valve Assembly, 2 <sup>nd</sup> Stage	1	70173-32000		1	70173-32000	
	Outlet Valve Assembly, 1 <sup>st</sup> Stage	2	70123-41000		2	70124-41000	
	Outlet Valve Assembly, 2 <sup>nd</sup> Stage	1	70123-41000		1	70123-41000	
	Breather Assembly	1	70103-57600-4024		1	70124-57600-4010	

## MAIN PARTS LISTING FOR TWO STAGE MODELS E-50 & E-71

DESCRIPTIONS	MODEL E50				MODEL E71			
	Qty Req'd	1 <sup>st</sup> Stage	Qty Req'd	2 <sup>nd</sup> Stage	Qty Req'd	1 <sup>st</sup> Stage	Qty Req'd	2 <sup>nd</sup> Stage
1. Inlet Valve Seat	2	70123-31010	1	70123-31010	2	70124-31010	1	70123-31010
2. Inlet Valve Receiver	2	70123-31020	1	70123-31020	2	70124-31020	1	70123-31020
3. Inlet & Outlet Valve Plate	4	70123-31030	2	70123-31030	4	70124-31030	2	70123-31030
4. Inlet Valve Spring	2	70123-31070	1	70123-31070	2	70124-31070	1	70123-31070
5. Inlet Valve Unloading Fork Guide	2	70123-31090	1	70123-31090	2	70124-31090	1	70123-31090
6. Unloading Spring	2	70123-11230	1	70123-11230	2	70124-11230	1	70123-11230
7. Inlet Valve Unloading Fork	2	70123-31080	1	70123-31080	2	70124-31080	1	70123-31080
8. Slotted Nut	2	92502-230800	1	92502-230800	2	92502-230800	1	92502-230800
9. Cotter Pin	2	93701-130220	1	93701-130220	2	93701-130220	1	93701-130220
10. Outlet Valve Seat	2	70123-41011	1	70123-41011	2	70124-41011	1	70123-41011
11. Outlet Valve Receiver	2	70123-41020	1	70123-41020	2	70124-41020	1	70123-41020
12A. Seat Gaskets	4	70123-11110	2	70123-11110	4	70124-11110	2	70123-11110

