

AIR COOLED, SINGLE STAGE MODEL ES-150

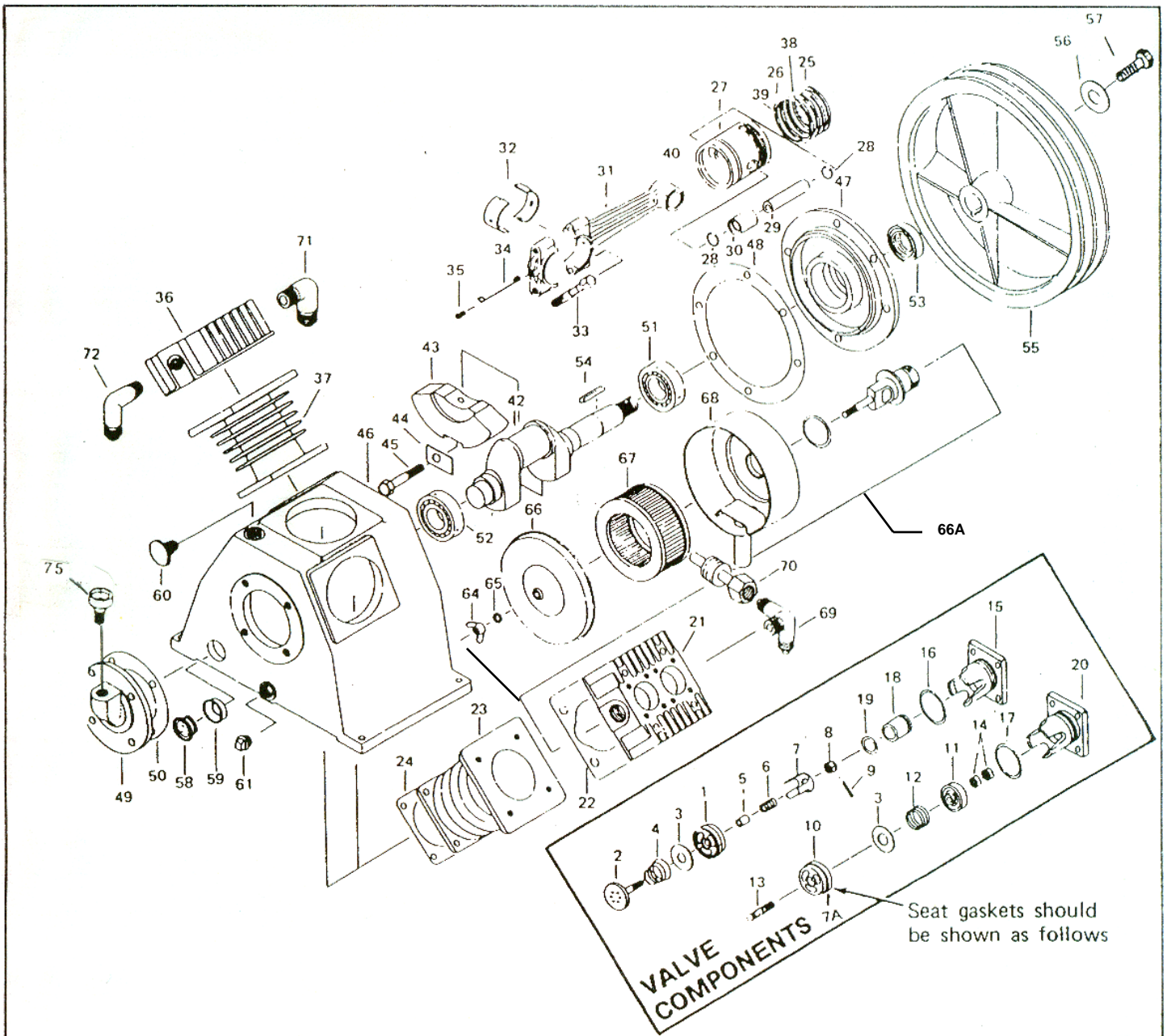

	DESCRIPTION	Qty. Req.	MODEL ES150
VALVE ASSEMBLIES	Inlet Valve Assembly, 1 st Stage	3	70125-31000
	Outlet Valve Assembly, 1 st Stage	3	70125-41000
	Breather Assembly	1	70124-57600

MAIN PARTS LISTING FOR MODEL ES-150

	DESCRIPTION	Qty. Req.	MODEL ES150
VALVE & UNLOADERS	1. Inlet Valve Seat	3	70125-31010
	2. Inlet Valve Receiver	3	70125-31021
	3. Inlet & Outlet Valve Plate	6	70125-31030
	4. Inlet Valve Spring	3	70125-31070
	5. Inlet Valve Unloading Fork Guide	3	70125-31090
	6. Unloading Spring	3	70125-11230
	7A. Valve Gasket	6	70125-11110

**MAIN PARTS LISTING FOR MODEL
ES-150 (Continued)**

CAP-600

	DESCRIPTION	Qty. Req.	MODEL ES150
VALVES & UNLOADERS (Cont'd)	7B. Inlet Valve Unloading Fork	3	70125-31080
	8. Locknut	3	92517-231200
	10. Outlet Valve Seat	3	70125-41011
	11. Outlet Valve Receiver	3	70125-41025
	12. Outlet Valve Spring	3	70125-41074
	13. Outlet Valve Bolt	3	70124-41810
	14. Nut (Outlet Valve)	6	92502-131000
	15. Inlet Valve Push Cover, 1 st Stage	3	70125-11151
	16. O – Ring G 65	3	93602-810065
	17. Viton O – Ring G 65 (Outlet Valve)	3	93602-870065
	18. Unloading Piston, 1 st Stage	3	70125-11220
	19. O – Ring P 22A	3	93601-870022A
	20. Outlet Valve Push Cover, 1 st Stage	3	70125-11451
	21A. Cylinder Head Assembly		70135-11000A
	21. Cylinder Head (1 st)	3	70125-11010
	21B. S/N A311XXXX AND LATER	3	70135-11011
	22. Cylinder & Head Gasket, 1 st Stage	3	70125-11612
	22A. S/N A311XXXX AND LATER	3	70135-11612
	23. Cylinder (1 st)	3	70135-51011
	23A. S/N 3020000 THRU A311XXXX	3	70135-51010
23B. S/N A311XXXX AND LATER	3	70135-51011	
24. Cylinder & Case Gasket	3	70135-51610	
25. Compression Ring (1 st)	6	70125-61030	
26. Oil Control Ring (1 st)	6	70125-61050	
27. Piston (1 st)	3	70125-61010	
27A. S/N 3020000 & later use	3	70135-61010-1	
28. Piston Pin Snap Ring	6	70125-61070	
29. Piston Pin (1 st)	3	70125-61120	
30. Connecting Rod Piston Pin Bushing (1 st)	3	70125-61081	
31. Connecting Rod Assembly, 1 st Stage	3	70125-61200	
31A. S/N 3020000 & later use	3	70125-61200	
32. Connecting Rod Crank Pin Metal	6	70125-61090	
33. Connecting Rod Bolt	6	70125-61250	
33A. Oil Splash Dipper H.P.		-	
34. Oil Splash Dipper	3	70135-61281	
35. Oil Splash Dipper Bolt	3	92501-130800	
CYLINDERS	42. Crankshaft	1	70135-56011
	43. Counterweight	2	70135-56031
	44. Lockwasher	2	70135-56830
	45. Bolt	2	70135-56811
	46. Crankcase	1	70135-57010-4024
	47. Front Bearing Cover	1	70135-57030
	48. Front Bearing Cover Gasket	1	70135-57950
	49. Rear Bearing Cover	1	70134-57061
	49A. S/N 3020000 & later use	1	70134-57061
	50. Rear Bearing Cover Gasket	1	70134-57960
	51. Front Bearing	1	93502-30310
	52. Rear Bearing	1	93502-32210
	53. Front Oil Seal	1	70134-57080
	54. V – Pulley Pin	1	70134-56060
	55A. Compressor Fan	1	70135-76310
	55B. Compressor Pulley	1	70135-76011
	56. Compressor Pulley Washer	1	70124-76210
	57. Compressor Pulley Set Bolt	1	91501-1312050
	58. Gauge Cover	1	70124-57700
	59. Gauge Cover Seal	1	70124-57730
	60. Crankcase Oil Cap	1	CCC1257
	61. Crankcase Oil Plug	1	90112-100404
	66A. Air Strainer Assembly	3	70123-66001
	67. Air Strainer Filter	3	70123-66140
	69. Outlet Pipe Joint B	1	70135-87021
	70. Compressor Body Discharge Piping Assy.	2	70135-87100 (Long)
	70A. S/N 3020000 & Later Use	2	70135-87200 (Short)
	71. Outlet Pipe Joint A	1	70135-87011
	73. Outlet Pipe Joint C	1	70135-87031
	74. Gasket (Manifold)	3	70125-87510
	Discharge Piping Assembly	1	70135-87700
	Discharge Piping Assembly	1	70135-87800
	Discharge Piping Assembly	1	70135-87900
	Copper Connector		-
	Copper Connector		-
	Copper Connector		-
	75. Breather Assembly	1	CCC1258