

AIR COOLED SINGLE STAGE MODELS ES-30, ES-50, ES-100

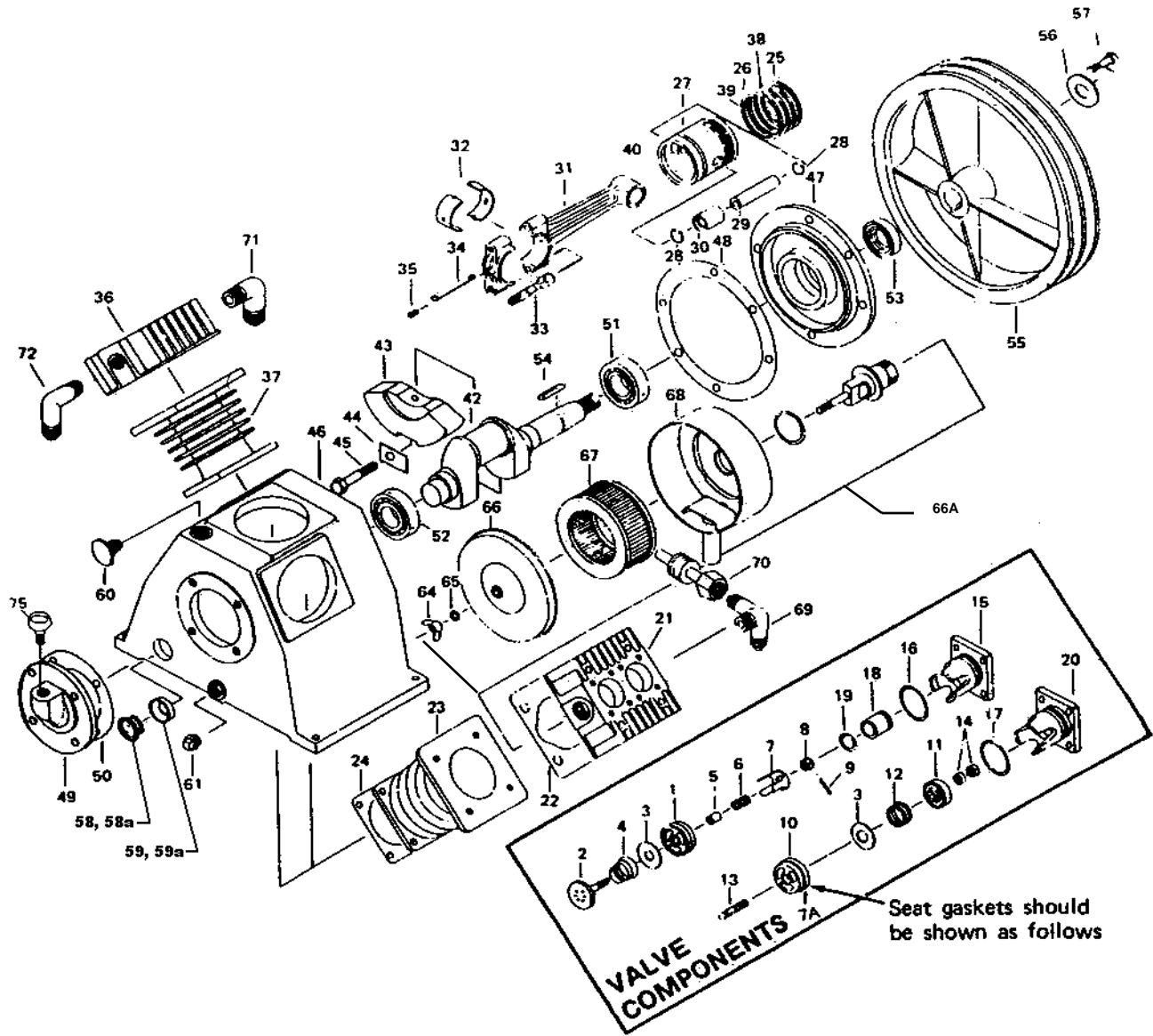

VALVE ASSEMBLIES	Description	Qty. Req.	MODEL ES30	Qty. Req.	MODEL ES50	Qty. Req.	MODEL ES100
		Inlet Valve Assembly, 1 st Stage	2	70123-31000	3	70123-31000	3
	Outlet Valve Assembly, 1 st Stage	2	70123-41000	3	70123-41000	3	70124-41000
	Breather Assembly	1	70103-57600-4024	1	70103-57600-4024	1	70124-57600

MAIN PARTS LISTING FOR MODELS ES-30, ES-50, ES-100

VALVE & UNLOADERS	Item No.	Description	Qty. Req.	MODEL ES30	Qty. Req.	MODEL ES50	Qty. Req.	MODEL ES100
		1.	Inlet Valve Seat	2	70123-31010	3	70123-31010	3
	2.	Inlet Valve Receiver	2	70123-31020	3	70123-31020	3	70124-31020
	3.	Inlet & Outlet Valve Plate	4	70123-31030	6	70123-31030	6	70124-31030
	4.	Inlet Valve Spring	2	70123-31070	3	70123-31070	3	70124-31070
	5.	Inlet Valve Unloading Fork Guide	2	70123-31090	3	70123-31090	3	70124-31090
	6.	Unloading Spring	2	70123-11230	3	70123-11230	3	70124-11230
	7A.	Valve Gasket	4	70123-11110	6	70123-11110	6	70124-11110

**MAIN PARTS LISTING FOR MODELS
ES-30, ES-50 & ES-100 (Continued)**

		Qty. Req.	MODEL ES30	Qty. Req.	MODEL ES50	Qty. Req.	MODEL ES100			
VALVES & UNLOADERS (Cont'd)	7B		Inlet Valve Unloading Fork	2	70123-31080	3	70123-31080	3	70124-31080	
	8.		Locknut	2	92518-230800	3	92518-230800	3	92518-230800	
	10.		Outlet Valve Seat	2	70123-41011	3	70123-41011	3	70124-41011	
	11.		Outlet Valve Receiver	2	70123-41020	3	70123-41020	3	70124-41020	
	12.		Outlet Valve Spring	2	70123-41070	3	70123-41070	3	70124-41070	
	13.		Outlet Valve Bolt	2	70123-41810	3	70123-41810	3	70124-41810	
	14.		Nut (Outlet Valve)	4	92502-130800	6	92502-130800	6	92502-130800	
	15.		Inlet Valve Push Cover, 1 st Stage	2	70123-11150	3	70123-11150	3	70124-11150	
	16.		O – Ring G 40	2	93602-810040	3	93602-810040	3	93602-810055	
	17.		Viton O – Ring G 40 (Outlet Valve)	2	93602-870040	3	93602-870040	3	93602-870055	
	18.		Unloading Piston, 1 st Stage	2	70123-11220	3	70123-11220	3	70124-11220	
	19.		O – Ring P 20	2	93601-810020	3	93601-810020	3	93601-810021	
	20.		Outlet Valve Push Cover, 1 st Stage	2	70123-11450	3	70123-11450	3	70124-11450	
	CYLINDERS	21A.		Cylinder Head Assembly	2	70123-11000	3	70123-11000		-
		21.		Cylinder Head (1 st)	2	70123-11010	3	70123-11010	3	70124-11010
		22.		Cylinder & Head Gasket, 1 st Stage	2	70123-11612	3	70123-11612	3	70124-11612
		23.		Cylinder (1 st)	2	70123-51012	3	70123-51012	3	70124-51011
		23A.		S/N 3020000 THRU A311XXXX	2	70123-51011	3	70123-51011	3	70124-51011
		24.		Cylinder & Case Gasket	2	70123-51610	3	70123-51610	3	70124-51610
		25.		Compression Ring (1 st)	4	70123-61030	6	70123-61030	6	70124-61030
26.			Oil Control Ring (1 st)	4	70123-61050	6	70123-61050	6	70124-61050	
27.			Piston (1 st)	2	70123-61011	3	70123-61011	3	70124-61011-1	
27A.			S/N 3020000 & later use	2	70123-61011	3	70123-61011	3	70124-61011	
28.			Piston Pin Snap Ring	4	70123-61070	6	70123-61070	6	70124-61070	
29.			Piston Pin (1 st)	2	70123-61120	3	70123-61120	3	70124-61120	
30.			Connecting Rod Piston Pin Bushing (1 st)	2	70123-61081	3	70123-61081	3	70124-61080	
31.			Connecting Rod Assembly, 1 st Stage	2	70123-61200	3	70123-61200	3	70124-61201	
31A.			S/N 3020000 & later use	2	70123-61201	3	70123-61201	3	70124-61201	
32.			Connecting Rod Crank Pin Metal	4	70123-61090	6	70123-61090	6	70124-61090	
33.			Connecting Rod Bolt	4	70123-61250	6	70123-61250	6	70125-61250	
33A.			Oil Splash Dipper H.P.		-	1	70122-61290	1	70134-62290	
34.			Oil Splash Dipper	2	70122-61282	2	70122-61282	2	70134-61281	
35.			Oil Splash Dipper Bolt	2	91507-2304012	3	91507-2304012	3	91507-2305016	
CRANKCASE & CRANK ASSEMBLY	42.		Crankshaft	1	70123-56010	1	70133-56011	1	70134-56010	
	43.		Counterweight	-	-	-	-	2	70134-56030	
	44.		Lockwasher	-	-	-	-	2	70124-56830	
	45.		Bolt	-	-	-	-	2	70124-56810	
	46.		Crankcase	1	70123-57010-4024	1	70133-57010-4024	1	70134-57010-4024	
	47.		Front Bearing Cover	1	70123-57030	1	70133-57030	1	70134-57031	
	48.		Front Bearing Cover Gasket	1	70123-57950	1	70123-57950	1	70124-57950	
	49.		Rear Bearing Cover	1	70123-57061	1	70133-57060	1	70134-57061	
	49A.		S/N 3020000 & later use	1	70123-57061	1	70133-57061	1	70134-57061	
	50.		Rear Bearing Cover Gasket	1	70123-57960-01	1	70133-57960	1	70134-57960	
	51.		Front Bearing	1	93501-6206	1	93501-6206	1	93502-32210	
	52.		Rear Bearing	1	93501-6206	1	93501-6206	1	93502-32210	
	53.		Front Oil Seal	1	70123-57080	1	70123-57080	1	70134-57080	
	54.		V – Pulley Pin	1	70123-56061	1	70123-56061	1	70134-56060	
	55A.		Compressor Fan	1	(Not Required)	1	(Not Required)	1	70124-76310	
	55B.		Compressor Pulley	1	70123-76010	1	70133-76010	1	70134-76011	
	56.		Compressor Pulley Washer	1	70123-76210	1	70124-76210	1	70124-76210	
	57.		Compressor Pulley Set Bolt	1	91501-1312030	1	91501-1312030	1	91501-1312040	
	58.		Gauge Cover	1	70111-57700	1	70111-57700	1	70124-57700	
	58 *A.		Oil Level Gauge Assy.	1	70704-57700	1	70704-57700		-	
	59.		Gauge Cover Seal	1	70111-57730	1	70111-57730	1	70124-57730	
	59 *A.		Oil Level Gauge "O" Ring	1	93602-8126026	1	93602-8126026		-	
	60.		Crankcase Oil Cap	1	CCC1257	1	CCC1257	1	CCC1257	
	61.		Crankcase Oil Plug	1	90112-100404	1	90112-100404	1	90112-100404	
	66A.		Air Strainer Assembly	2	70123-66000	3	70123-66000	3	70123-66000	
67.		Air Strainer Filter	2	70123-66140	3	70123-66140	3	70123-66140		
69.		Outlet Pipe Joint B	1	70123-87020	1	70133-87020	1	70134-87020		
70.		Compressor Body Discharge Piping Assy.	1	70123-87100	2	70133-87101	2	70134-87100		
70A.		S/N 3020000 & Later Use	1	70123-87101	2	70133-87101	2	70134-87101		
71.		Outlet Pipe Joint A	1	70123-87010	1	70123-87010	1	70124-87010		
73.		Outlet Pipe Joint C		-	1	70133-87030	1	70134-87030		
74.		Gasket (Manifold)		-		-		-		
75.		Breather Assembly	1	CCC1375	1	CCC1375	1	CCC1375		

* ES30, START S/N AS4030091

* ES50, START S/N AS4030115